

Lewes Research Institute

Lewes

The following drawings map out the plans for the Lewes Research Institute, along with flood strategies and space analysis through previously explored case studies.



The Lewes Research institute aims to develop the science that underpins conservation and tackles the more applied questions of how biodiversity can survive in the post human condition. The work focuses on a range of issues; including conservation and livelihoods of native plants and animals, ecosystem services, management of endangered species, re-wilding of natively extinct species, human-wildlife co-existence and sustainable agriculture.

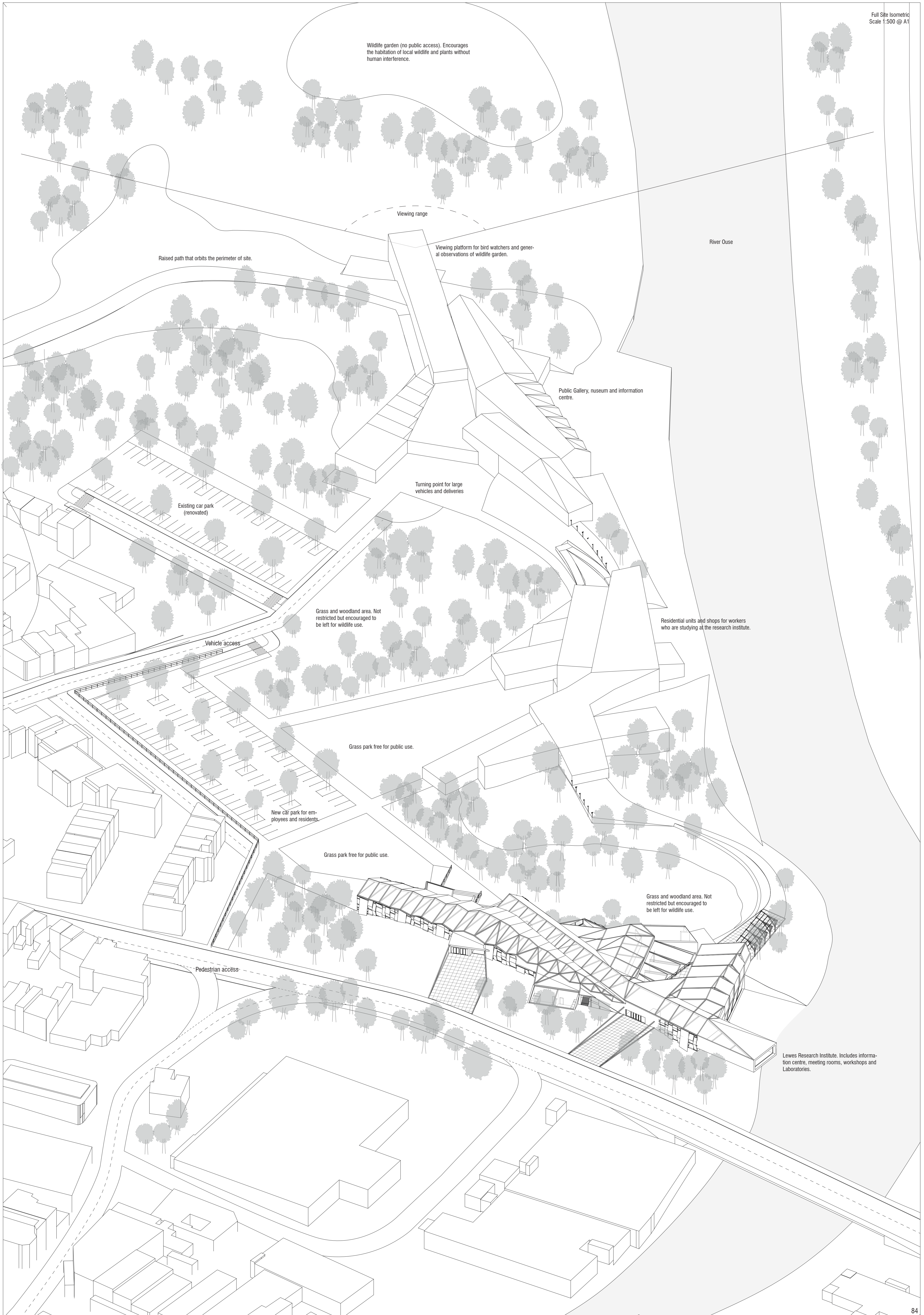

Wildlife garden (no public access). Encourages the habitation of local wildlife and plants without human interference.

Viewing range

Raised path that orbits the perimeter of site.

Viewing platform for bird watchers and general observations of wildlife garden.

River Ouse

Public Gallery, museum and information centre.

Turning point for large vehicles and deliveries

Existing car park (renovated)

Grass and woodland area. Not restricted but encouraged to be left for wildlife use.

Residential units and shops for workers who are studying at the research institute.

Vehicle access

Grass park free for public use.

New car park for employees and residents.

Grass park free for public use.

Grass and woodland area. Not restricted but encouraged to be left for wildlife use.

Pedestrian access

Lewes Research Institute. Includes information centre, meeting rooms, workshops and Laboratories.

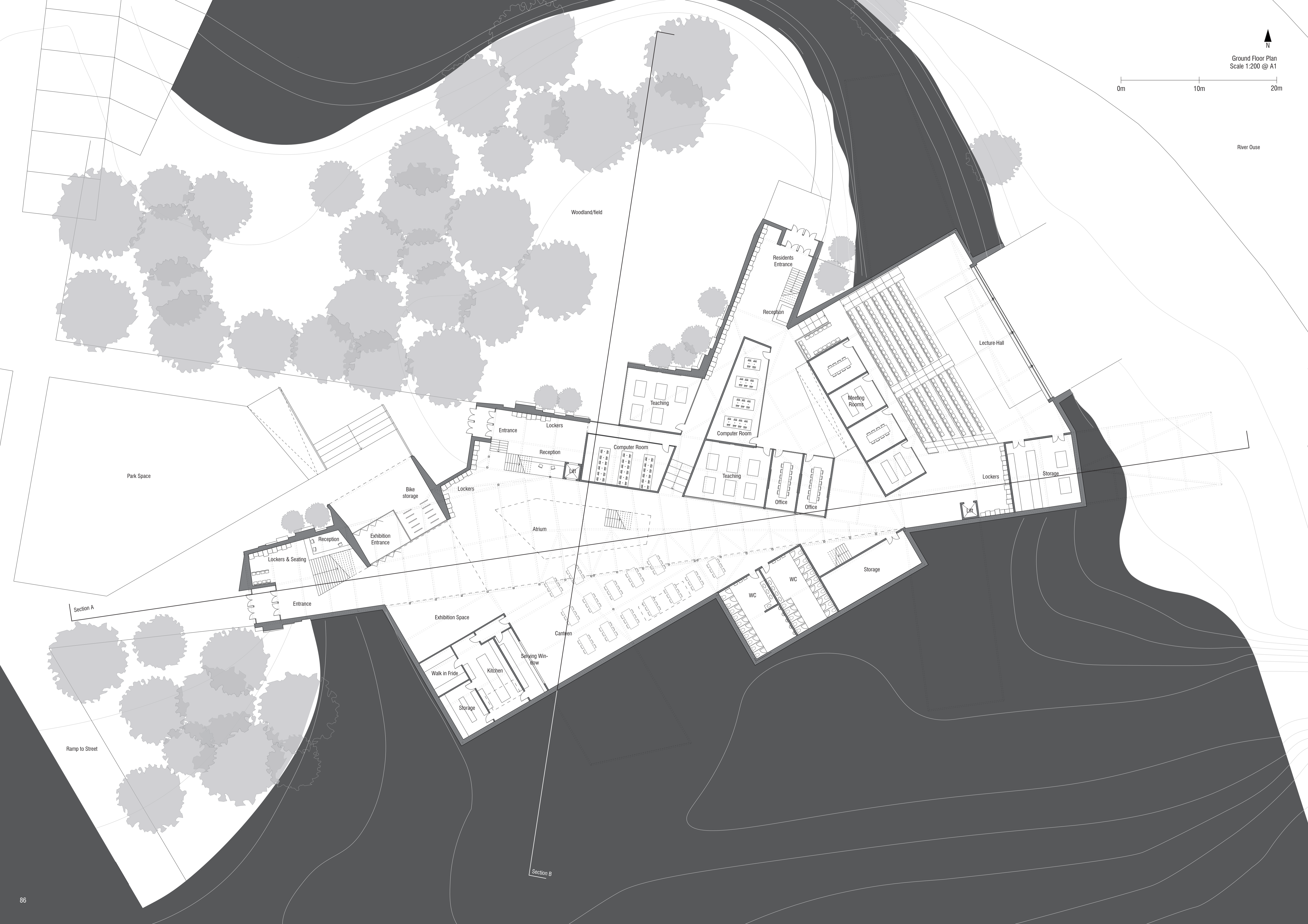



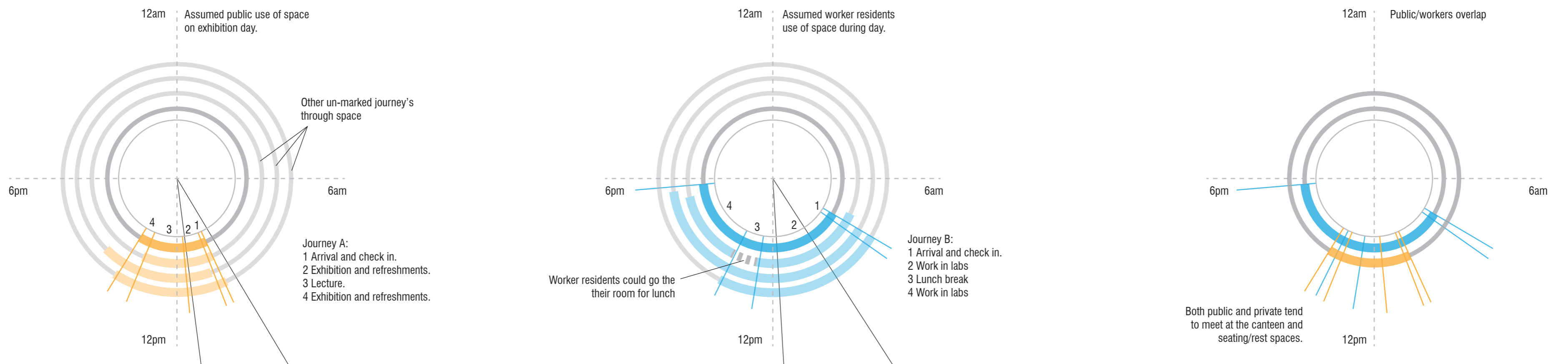

First Floor (private)

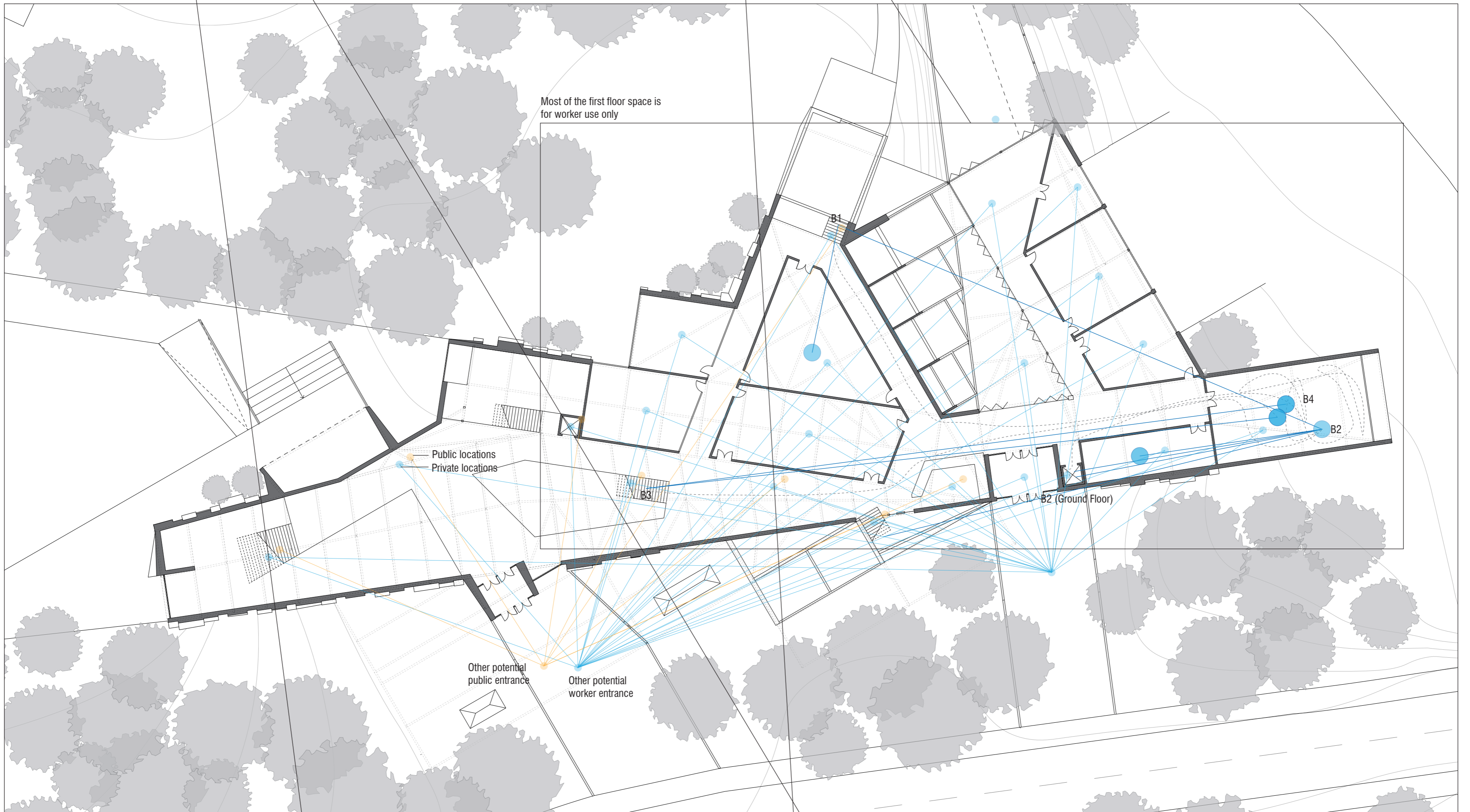

Ground Floor (public)





Woodland/field

Perimeter Path

Outdoor seating

Park Space

Section A

Ramp to Street

Section B

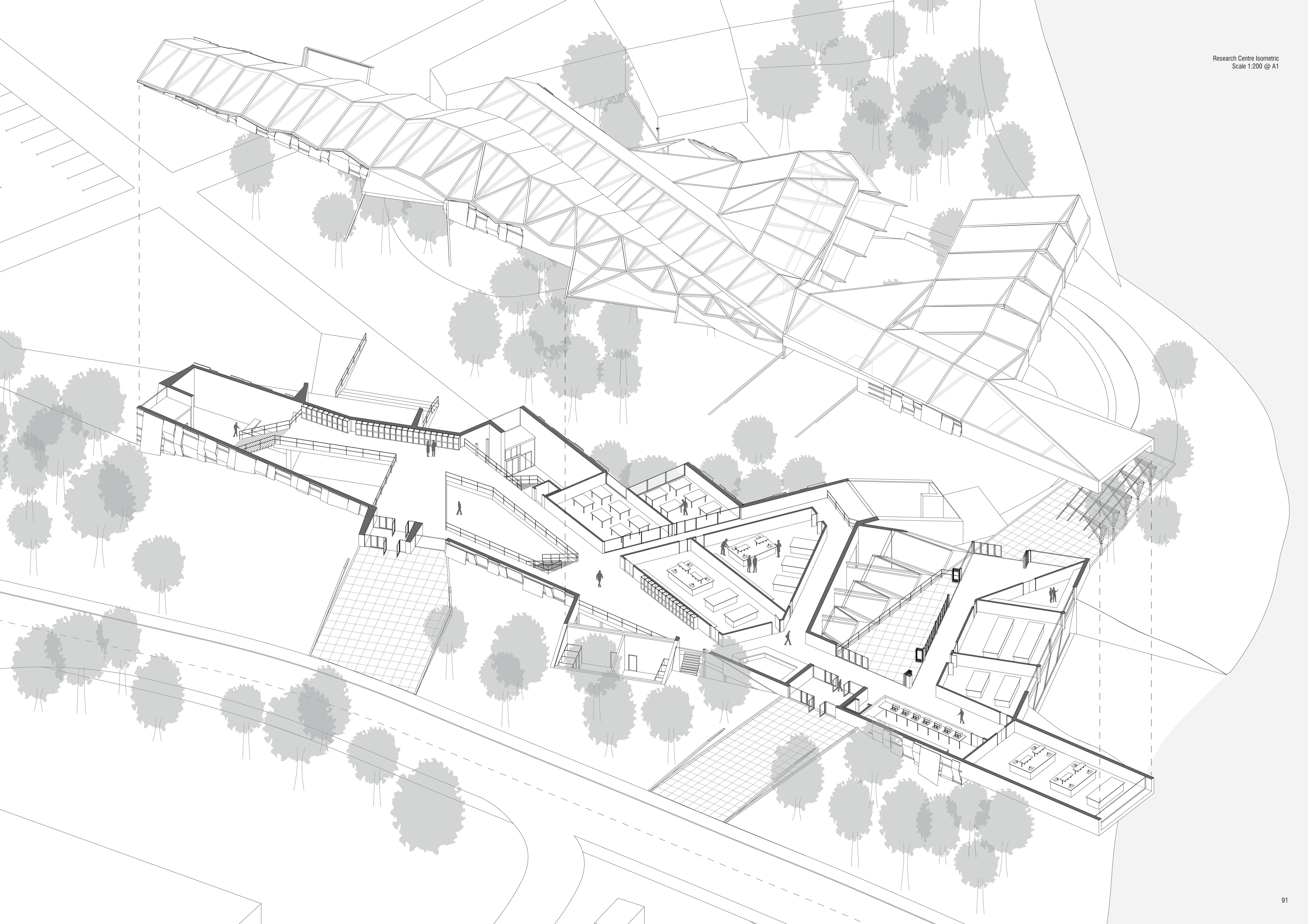

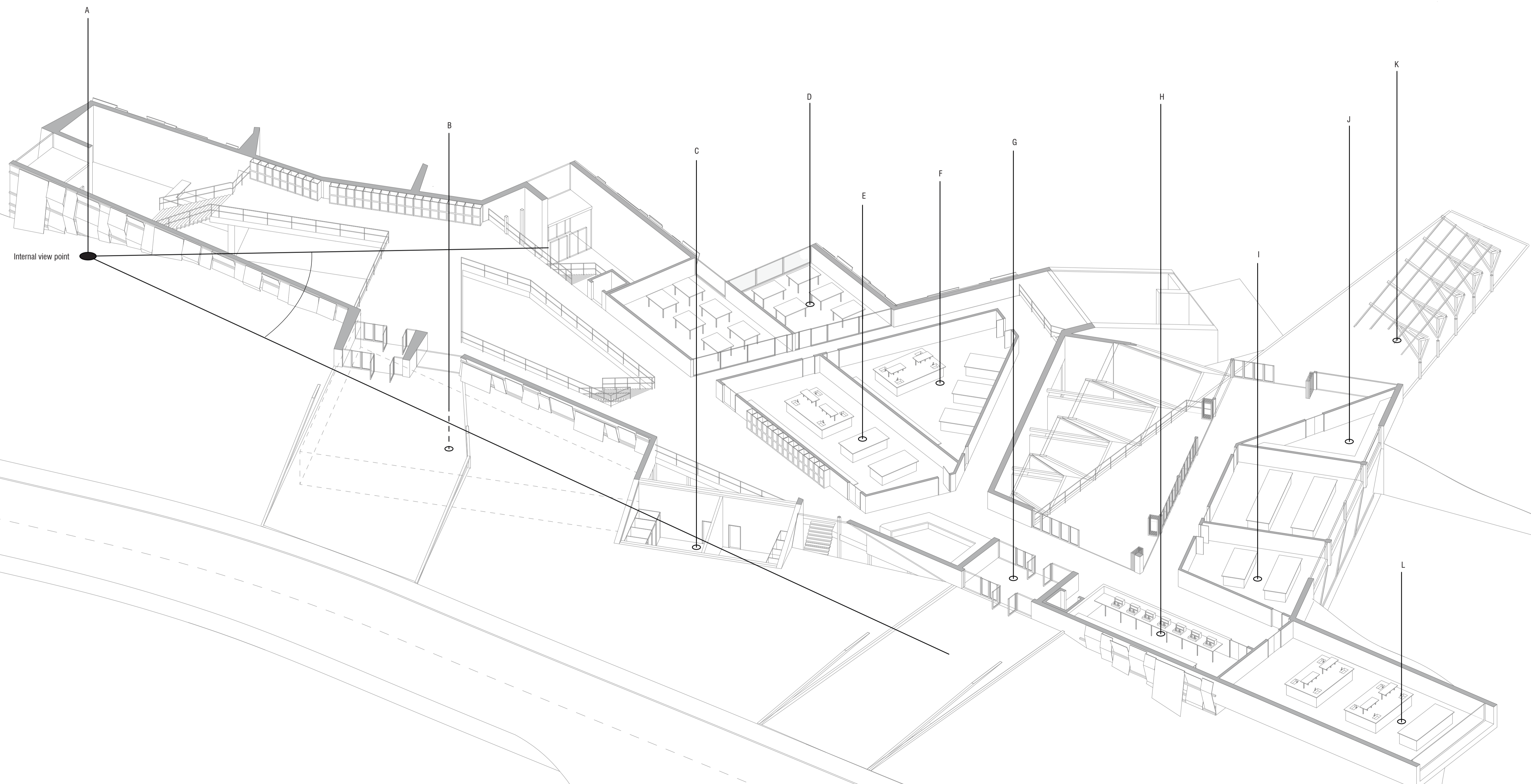
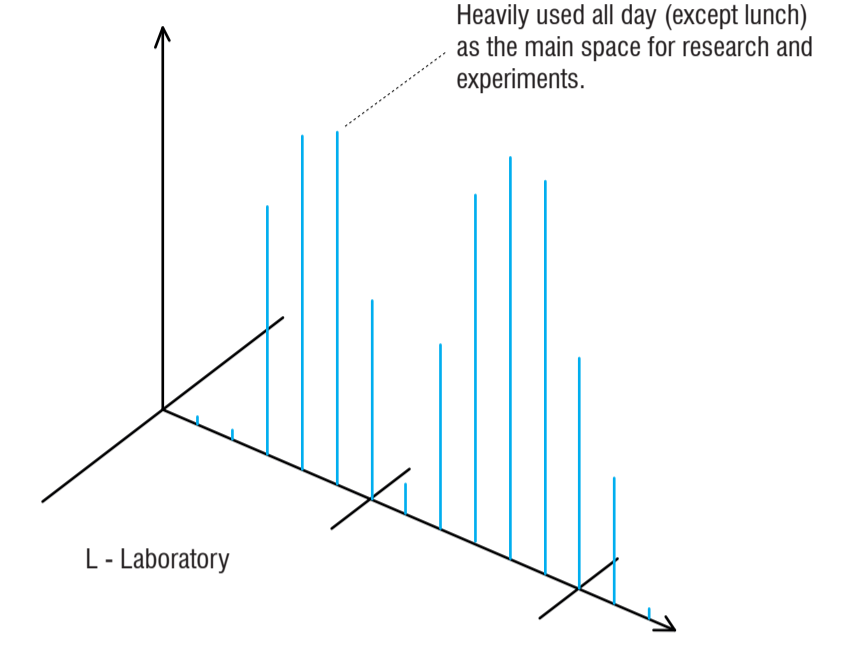
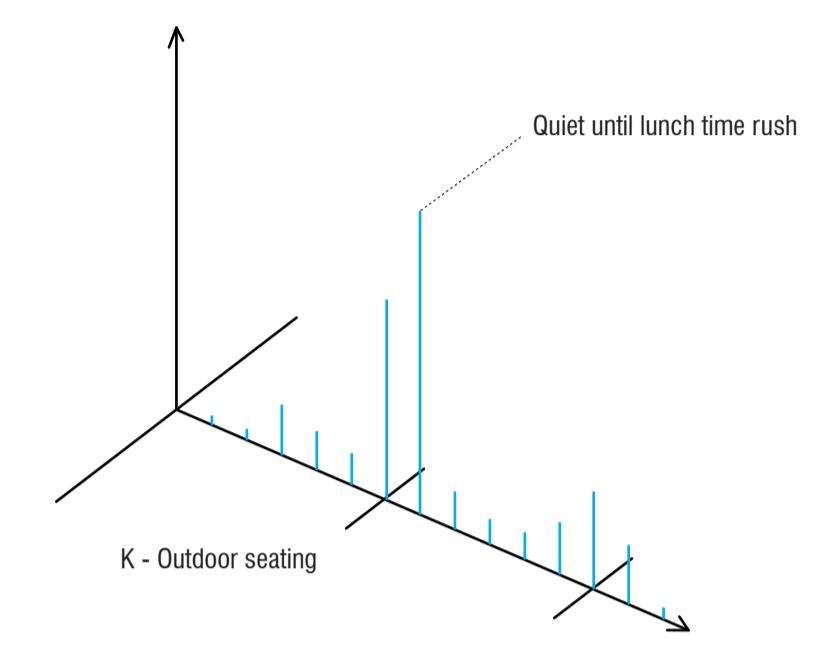
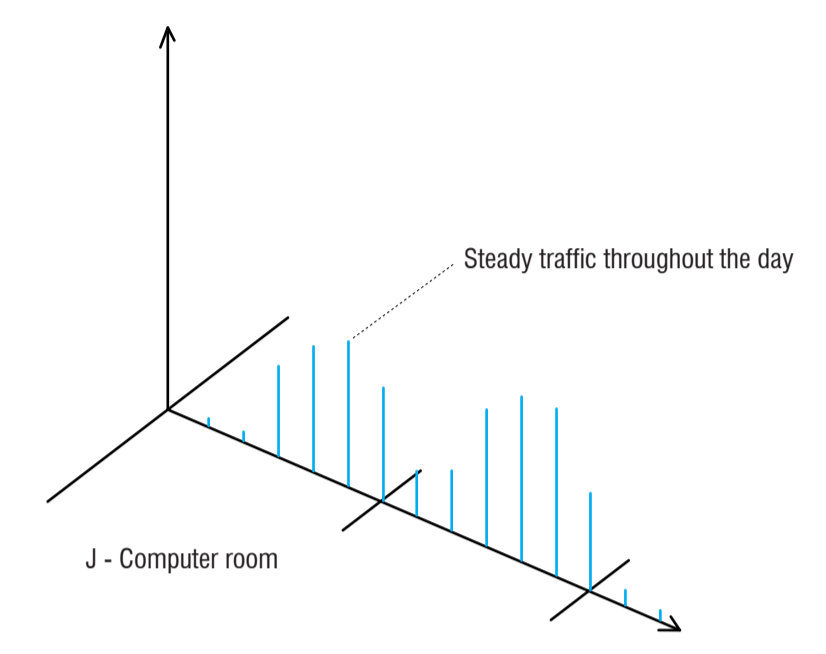
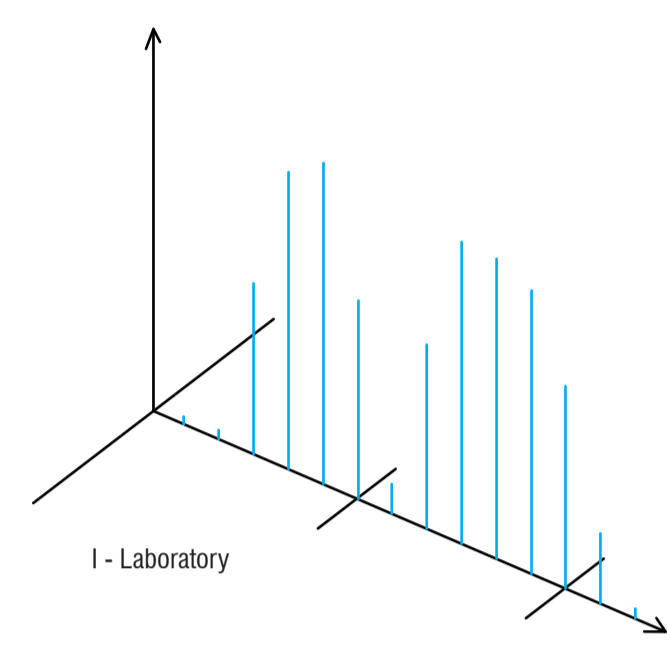
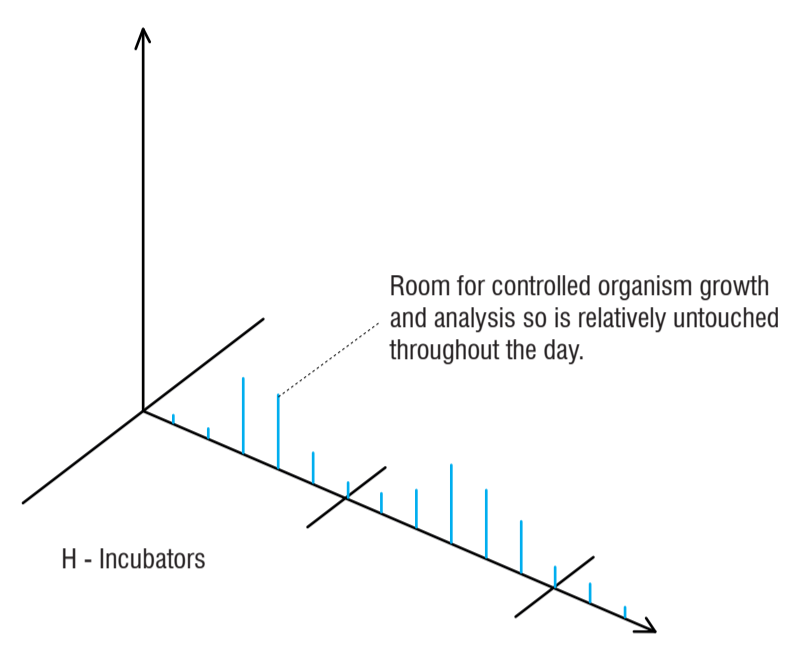
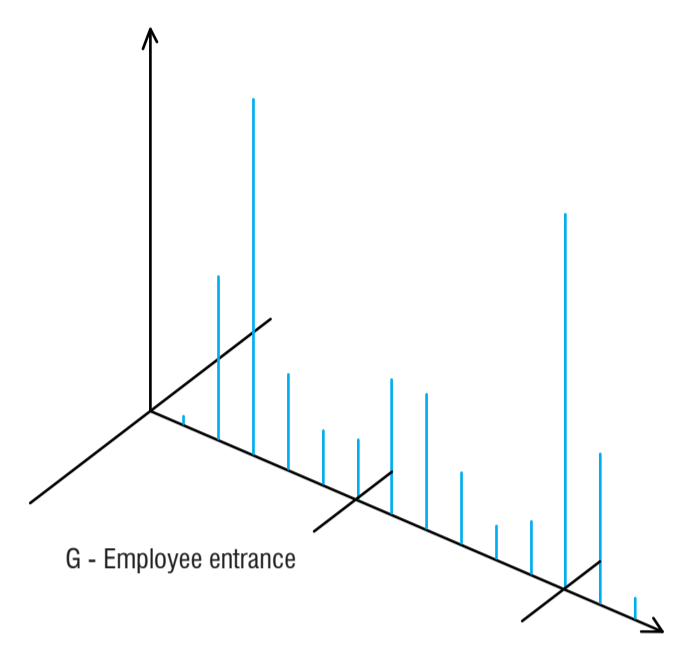
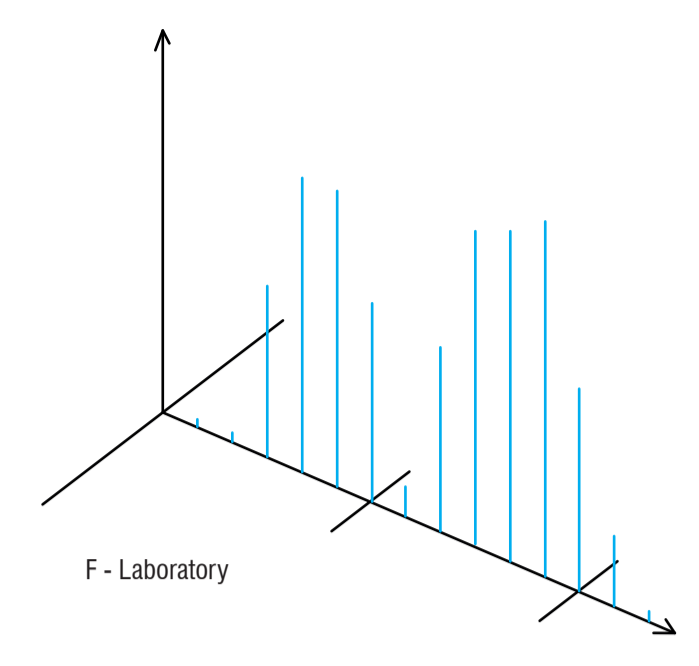
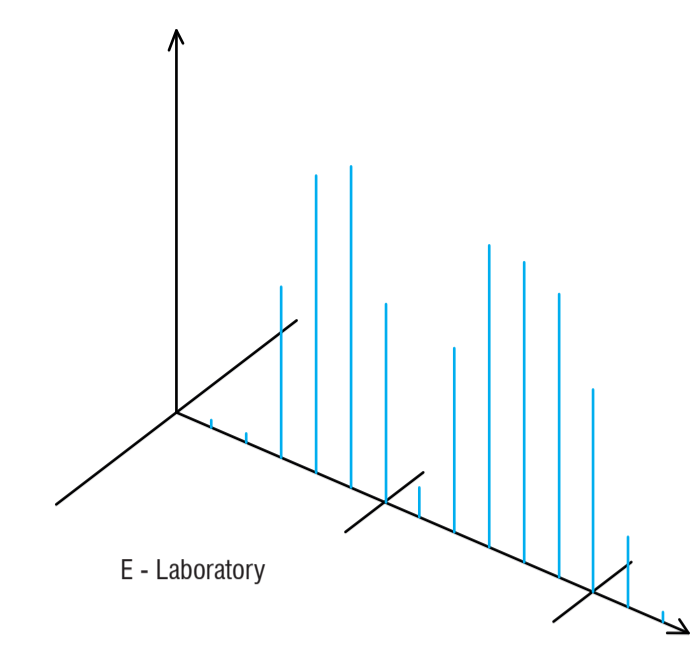
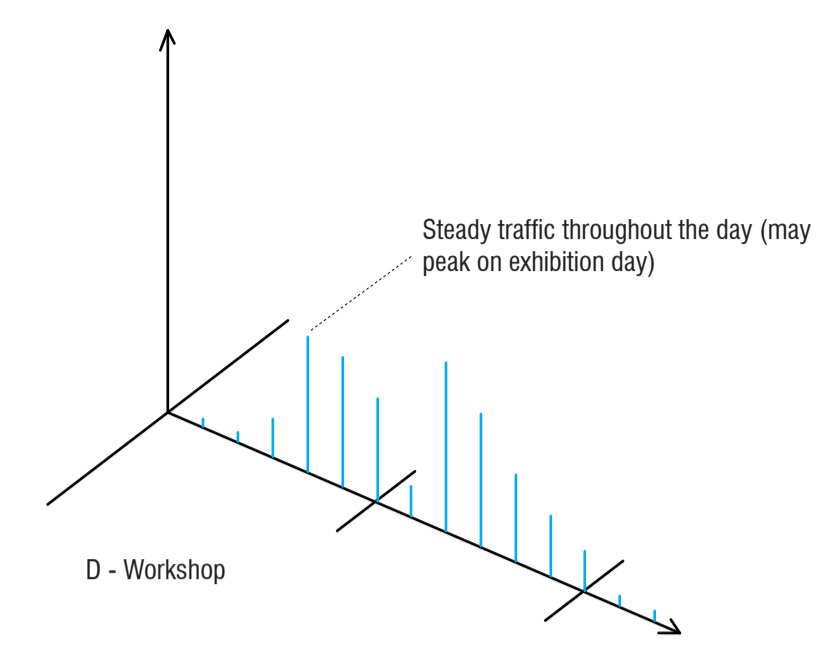
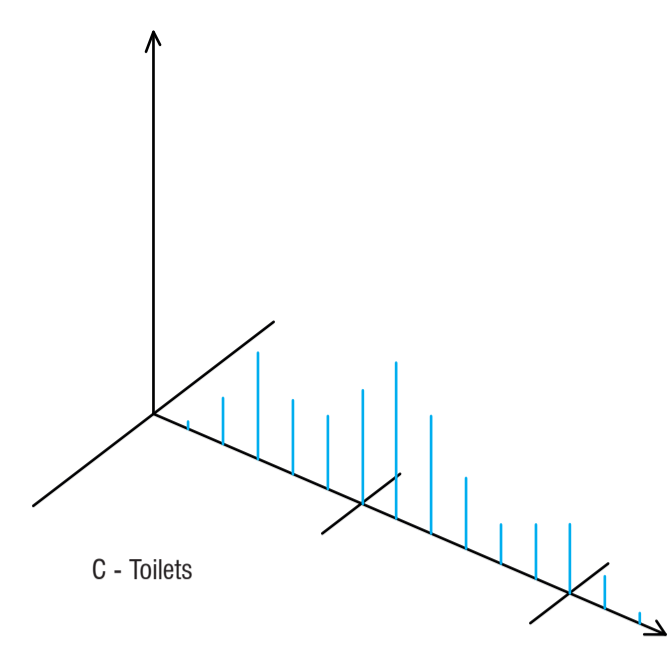
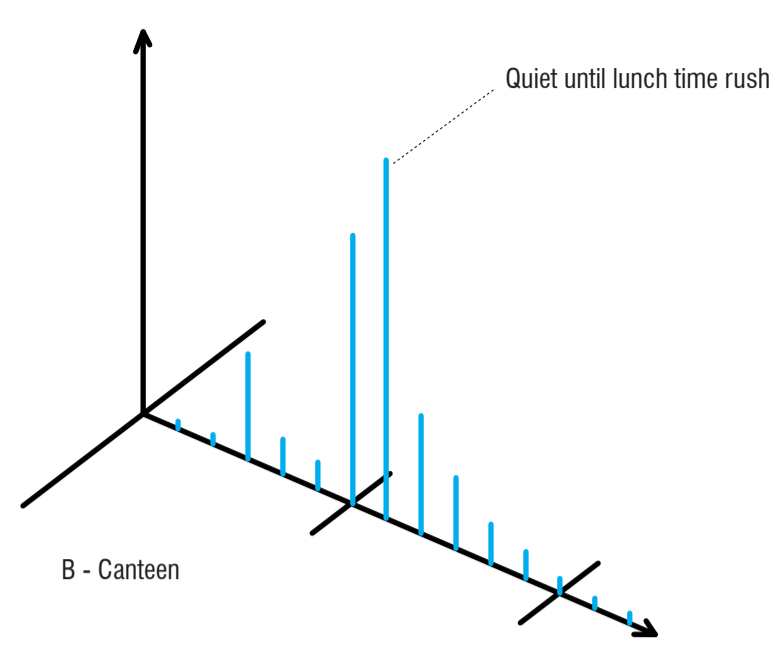
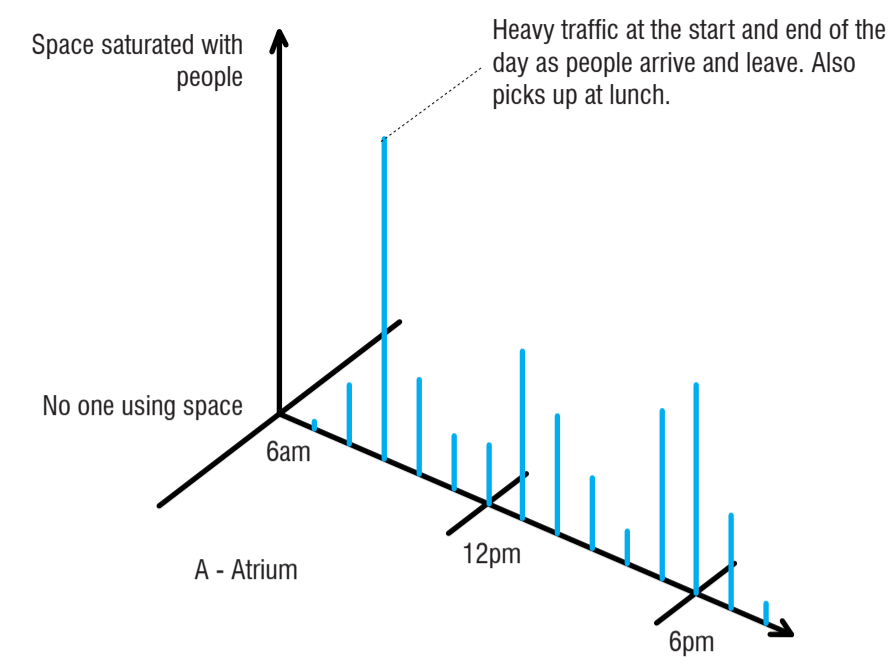

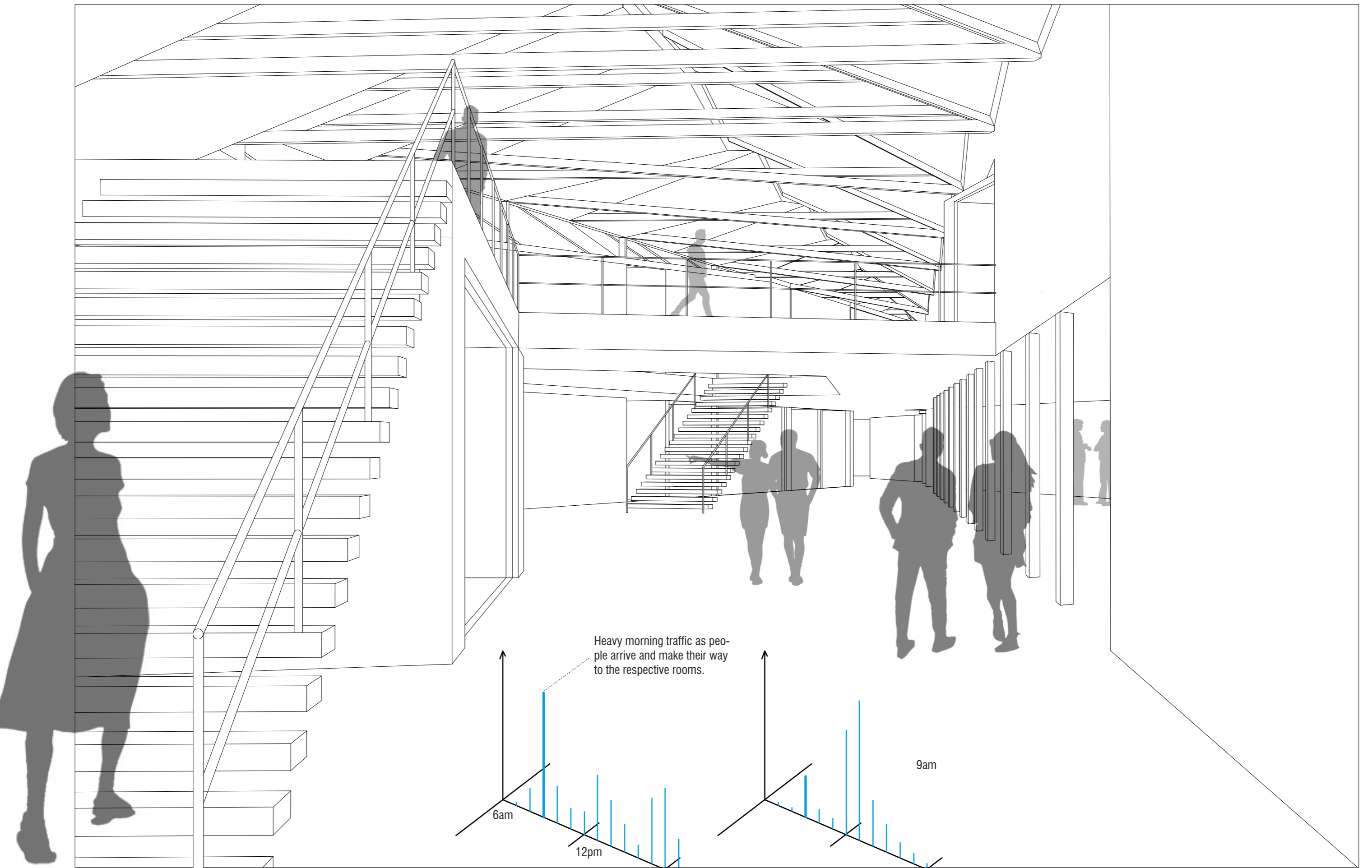

Heavy morning traffic as people arrive and make their way to the respective rooms.

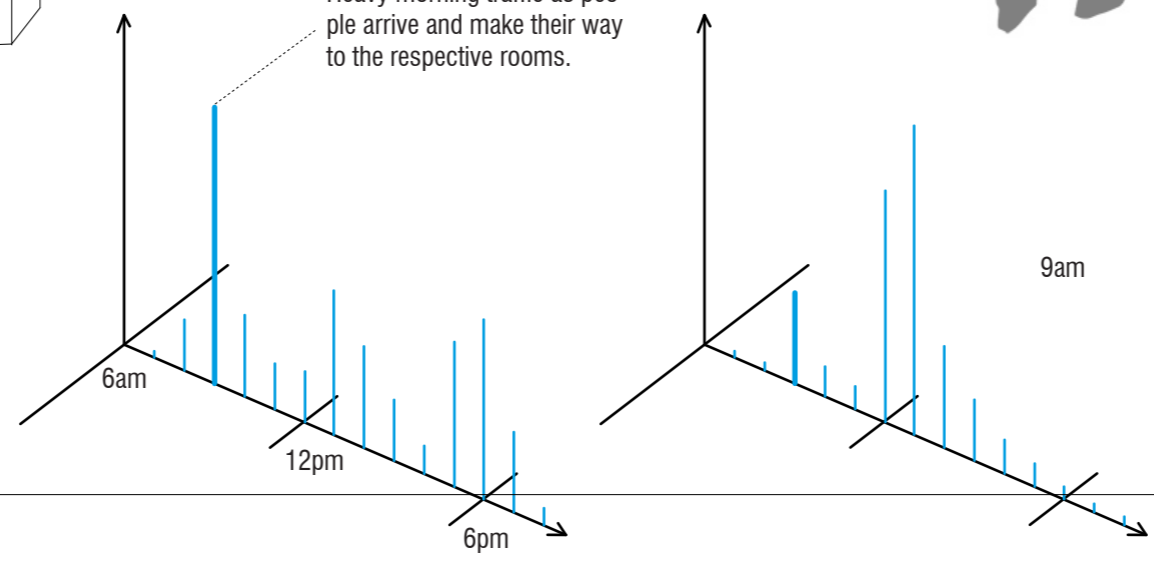

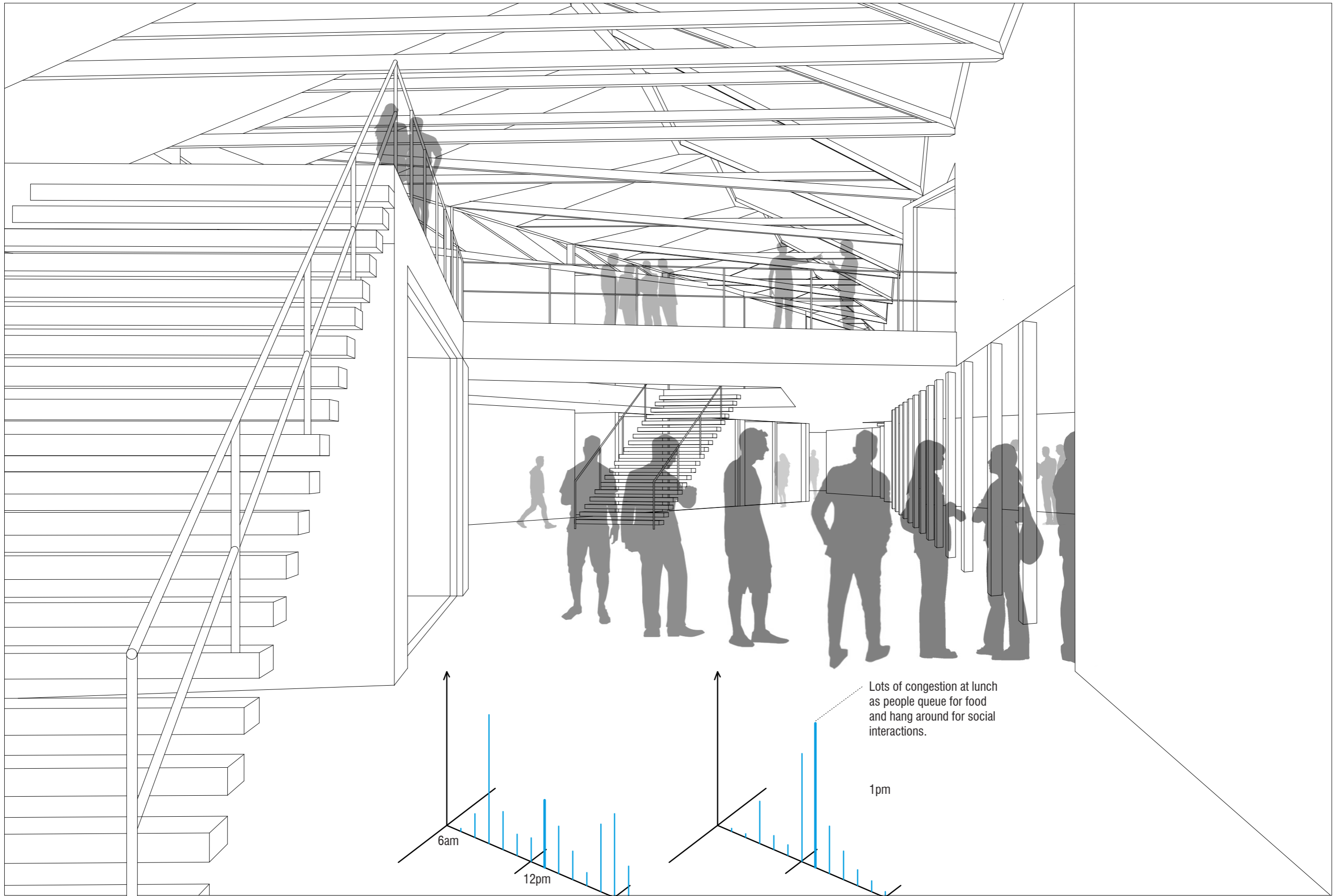

Lots of congestion at lunch as people queue for food and hang around for social interactions.

1pm

6am

12pm

6pm

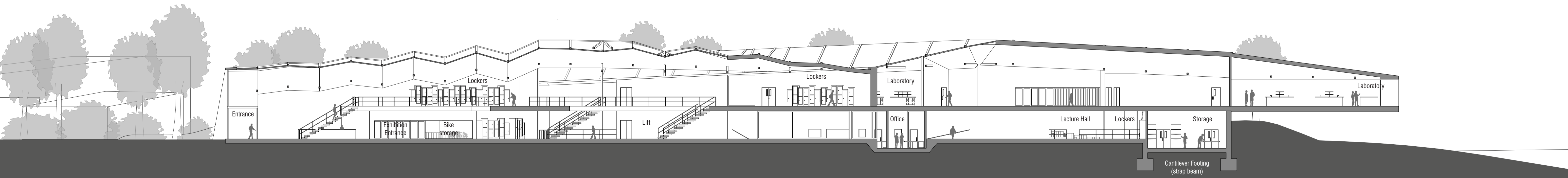
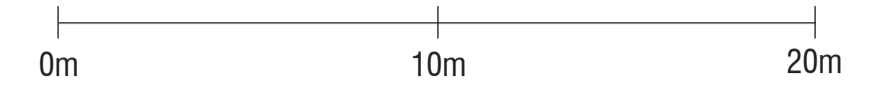



Perimeter Path



Workshop

Computer Room

Canteen

Foundation for retaining wall

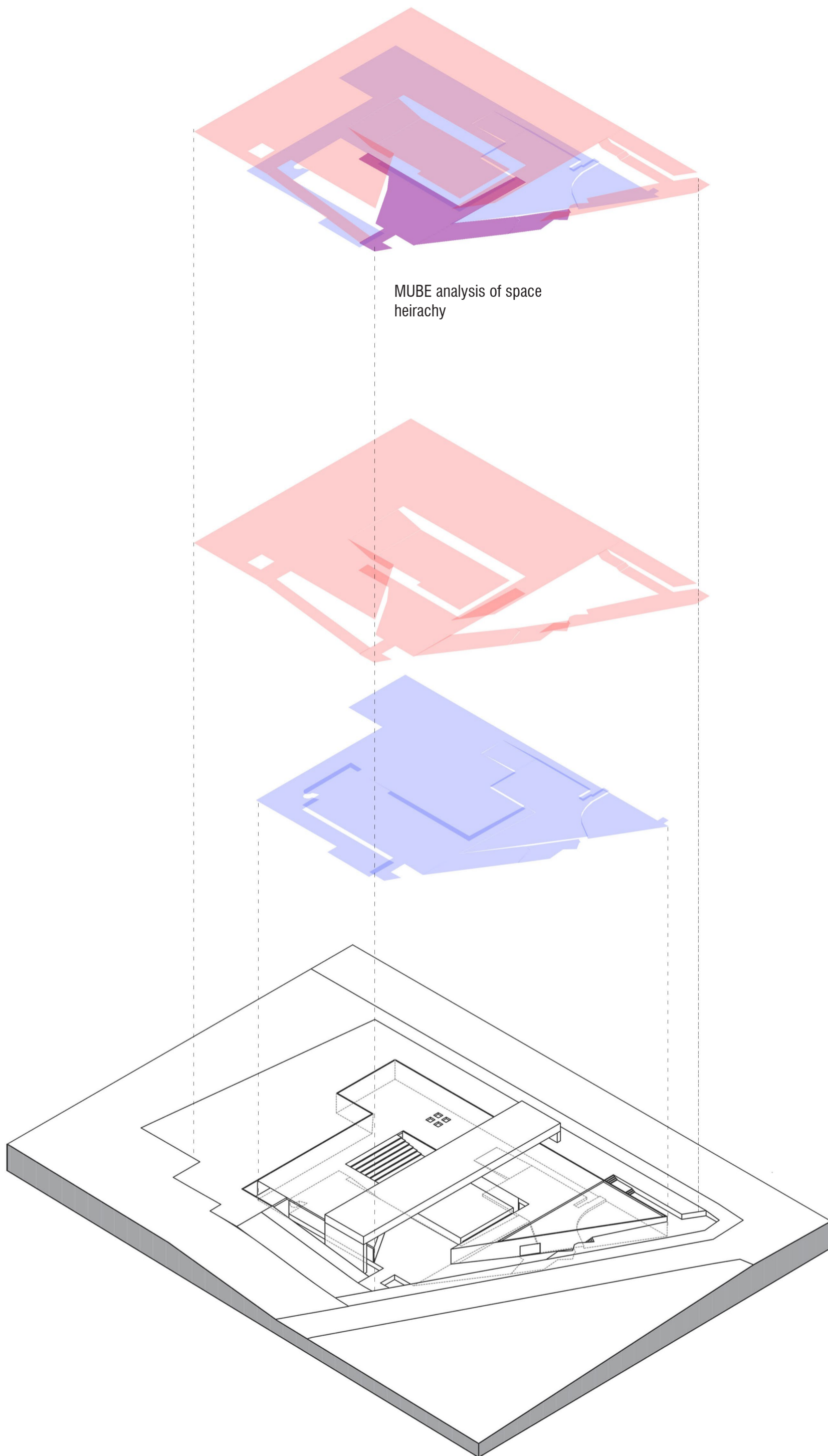

Space Hierachy

The important and expensive spaces (labs, computer rooms and workshops) are at this level and well protected from flooding.

First floor level extends around site and becomes flood defence.

Ground floor

Ground floor
(Lower)

Scale 1:500 @ A3

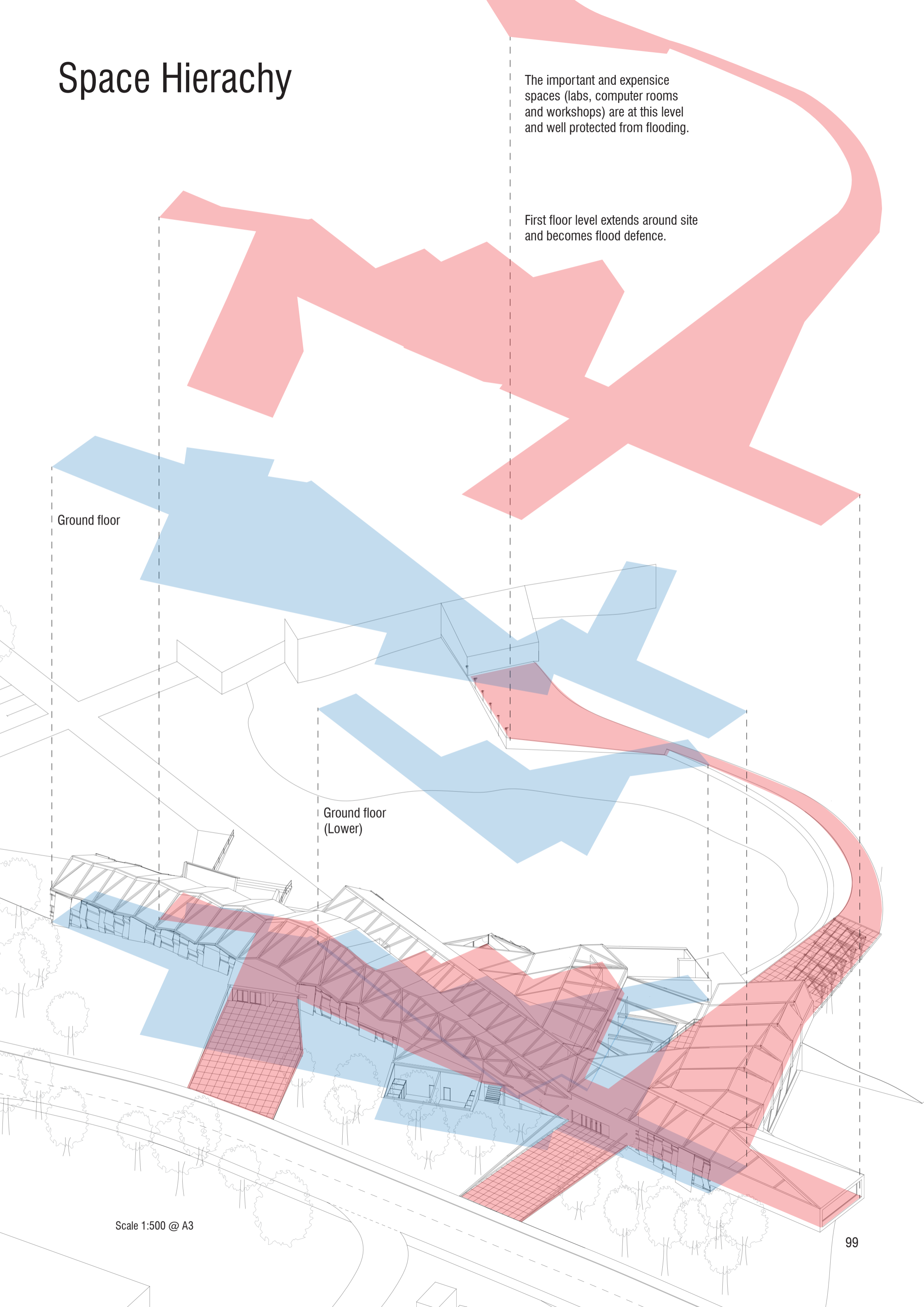

Flood Strategy

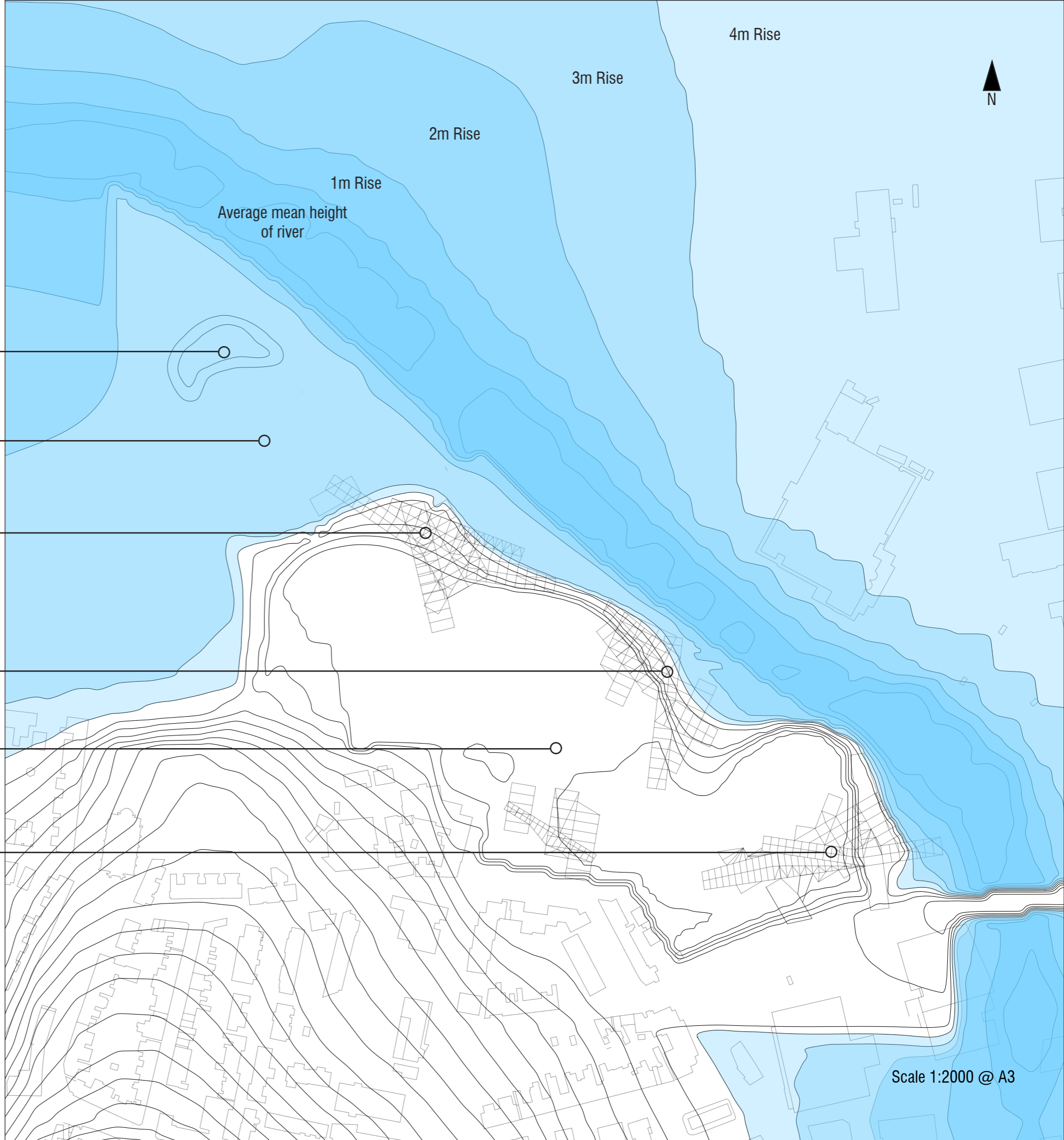

Island. May be submerged in extreme flooding events but mostly acts as land for animals in common floods. Not too high to impede view from viewing hut.

Nature garden is not protected from large scale floods and will be submerged in those rare events.

Building acting as flood defence as it cuts through the raised ground flood defence.

Building acting as flood defence as it cuts through the raised ground flood defence.

Area protected by surrounding ground wall. Areas that require the most protection will be situated here (car parks, generators etc).

Building acting as flood defence as it cuts through the raised ground flood defence.

Flood Defences

Sectional representation of how the raised ground acts as a flood defence for the site. The bank will protect up to a 5m rise in water level from high tide.

The defence uses the ground as a more organic and free flowing way to defend against the water from a conventional flood wall.

With this, there is opportunity for plants and wildlife to inhabit the bank, something they could not do with the existing concrete wall. This is also higher than the concrete wall, granting the site greater defence to flooding.

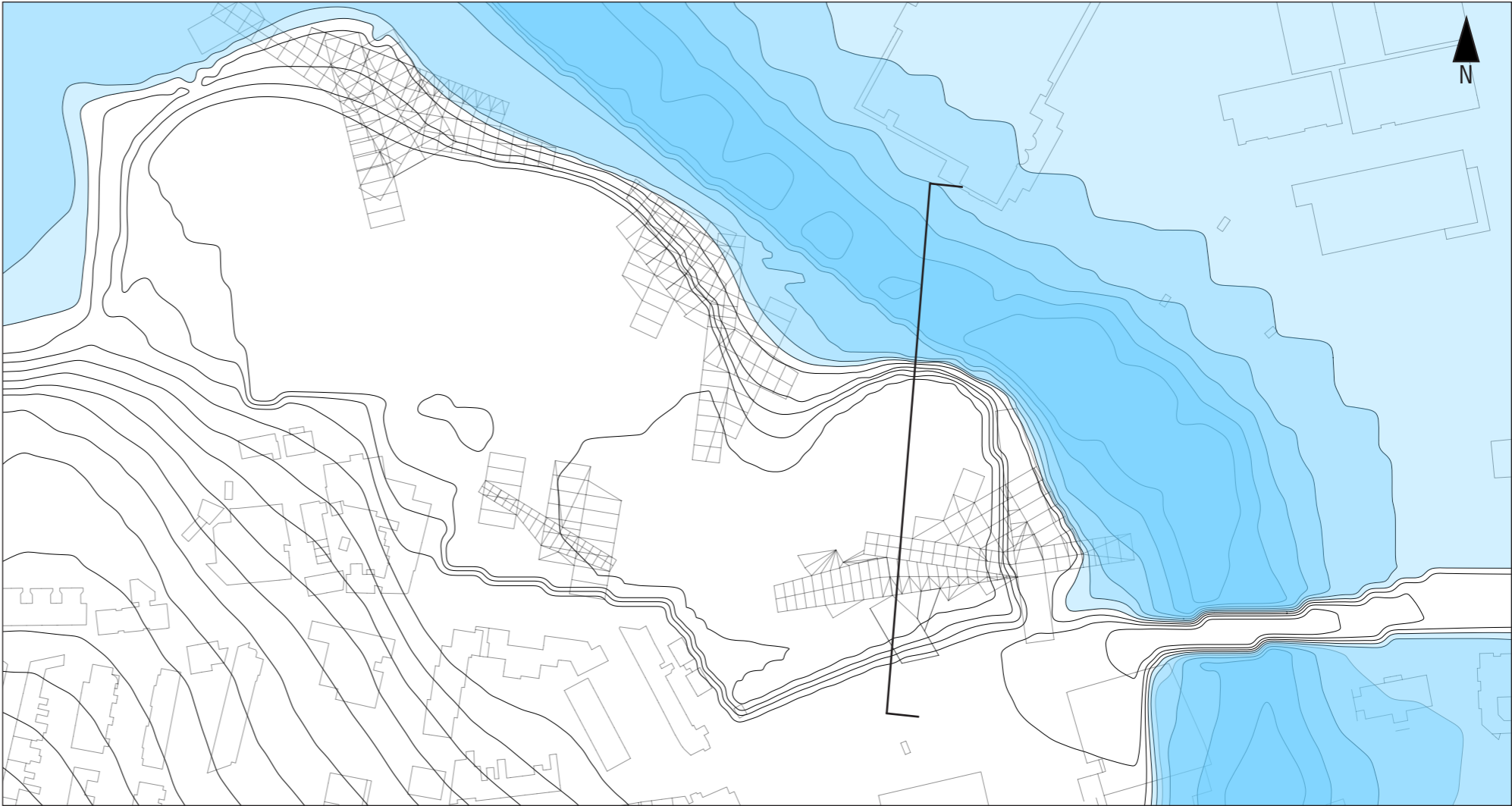

Scale 1:2000 @ A3

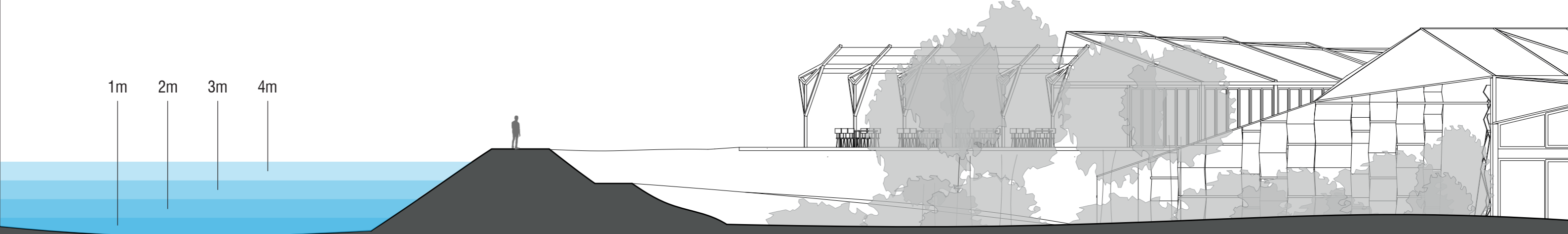

Average high tide

Scale 1:200 @ A3

Location of perspective view

Roof plan
Scale 1:500 @ A3

Hills of the South Downs

Woodland area leading to
rewilding wall

Trees frame view of building
from car park

Park area for human use and leisure

